

PRIME RETAIL SPACE ON GRAND RIVER AVENUE

LOCATED IN THE HEART OF OKEMOS' RETAIL CORRIDOR



FOR LEASE
2049 W Grand River
Okemos, MI

AVAILABLE:
4,563 SF



CARSON PATTEN, CCIM
Vice President, Retail Advisor
Direct: 517 319-9230
carson.patten@martincommercial.com

SAMANTHA LE
Senior Associate, Retail Advisor
Direct: 517 319-9279
samantha.le@martincommercial.com





MODERN STOREFRONT SPACE SURROUNDED BY AFFLUENT DEMOGRAPHICS

Positioned along Grand River Avenue in the center of Okemos' premier retail and dining corridor, this modern 4,563 SF space offers an exceptional opportunity to serve one of the region's most affluent and active consumer bases. Built in 2016, the suite features large windows, doorstep parking, and a flexible layout that can accommodate a wide variety of retail, showroom, service, or specialty users seeking a highly visible location in a thriving commercial district.

Surrounded by national retailers, popular restaurants, upscale residential neighborhoods, and Michigan State University just minutes away, the property benefits from strong traffic counts, excellent demographics, and consistent consumer activity. Prominent pylon and building signage further enhance visibility.

LEASE RATE:
\$20.00-25.00
PSF/YR, NNN

PROPERTY FEATURES



BUILT:
2016



LAYOUT:
Flexible for a Variety
of Users



LOCATION:
Okemos' Primary
Retail and Dining
Corridor



DEMOGRAPHICS:
Affluent



NEAR:
Michigan State
University



SIGNAGE:
Pylon and Building





FLOOR PLAN

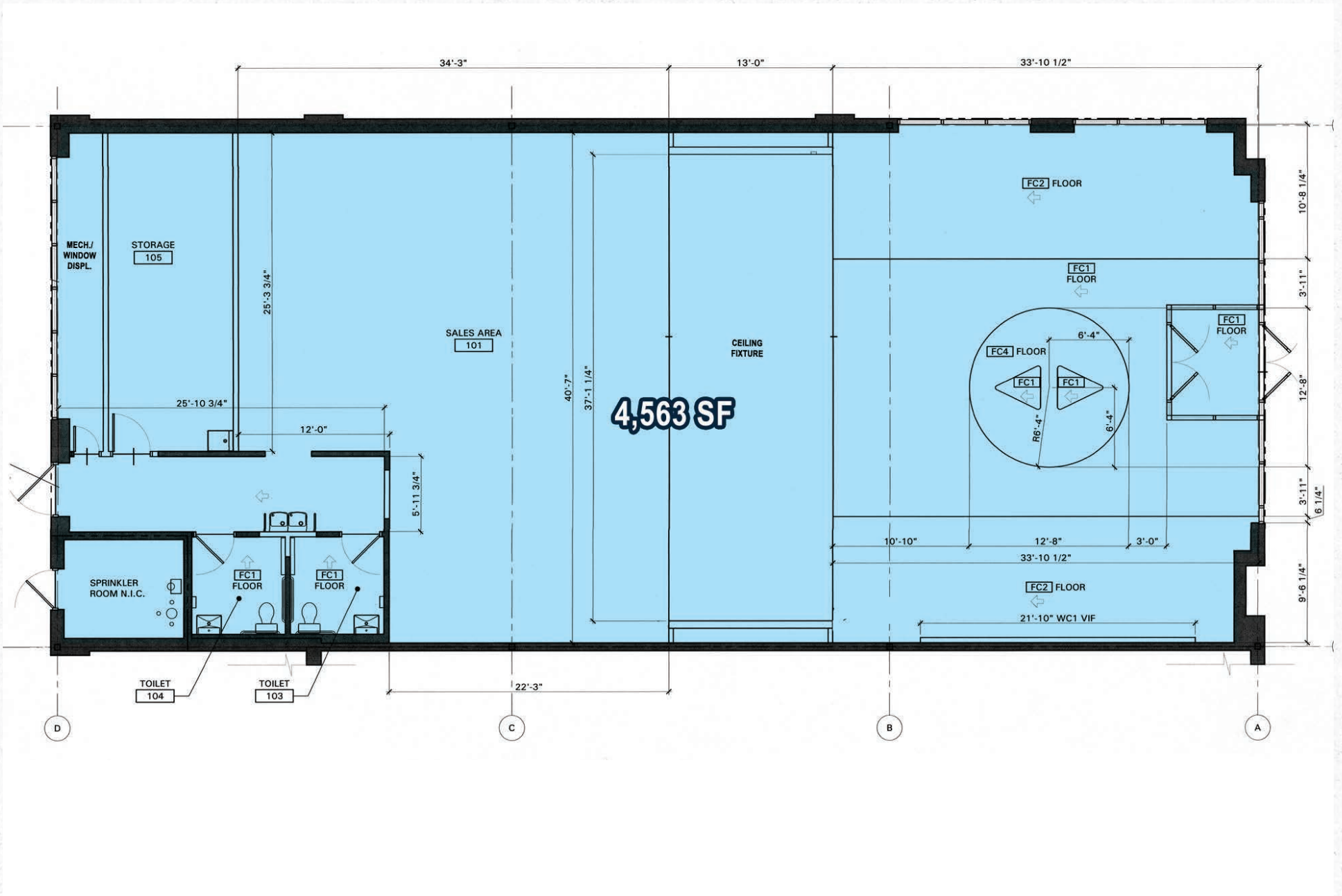



GALLERY

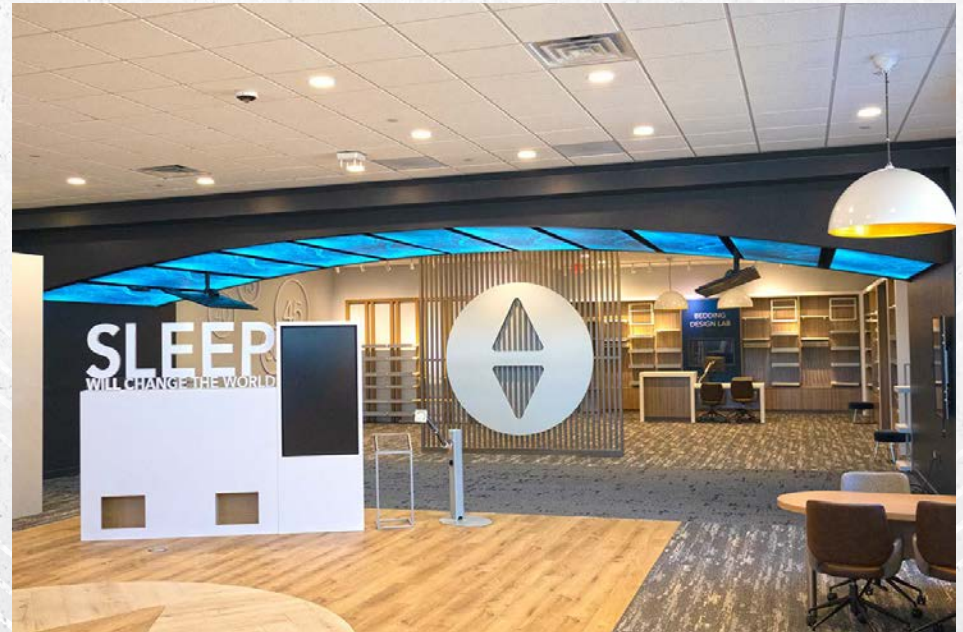



AREA INFORMATION

Minutes

to Meridian Mall with national retailers; Dick's Sporting Goods, H&M, Macy's, Schuler Books, and more

Minutes

to popular national restaurants; Chick-fil-A, Chipotle Mexican Grill, Panera Bread, Taco Bell, Olive Garden, Chili's, and more

<3 Miles

to Michigan State University, downtown East Lansing, and student housing

Convenient

to many surrounding housing units, apartment complexes, and neighborhoods



DEMOGRAPHICS

Proximity	1-Mile	3-Miles	5-Miles
Population	4,702	57,040	112,539
Households	1,966	21,535	43,314
Average HH Income	\$159,006	\$123,299	\$108,601

TRAFFIC COUNTS - VPD

W Grand River Ave.	23,114
Okemos Rd.	22,552
Marsh Rd.	15,916



Martin Your Vision. Our Mission.

Martin Commercial Properties is a vertically integrated commercial real estate firm with an established track record of delivering superior service and unparalleled results to clients since 1962. Our experienced team efficiently serves clients nationally by combining big business benefits with the attentiveness to detail and insight that you would expect from a local firm. With offices in Lansing, Grand Rapids, and Tampa, we provide strategic advice and execution in five core lines of business including brokerage services, investment services, property management, property development, and corporate services.



Brokerage
Services



Property
Management



Construction
Services



Investment
Services



Corporate
Services

martincommercial.com | East Lansing | Grand Rapids | Tampa

© 2026 Martin Commercial Properties, Inc. All rights reserved. This information has been obtained from sources believed reliable but has not been verified for accuracy or completeness. You should conduct a careful, independent investigation of the property and verify all information. Any reliance on this information is solely at your own risk. Martin Commercial Properties and the Martin logo are service marks of Martin Commercial Properties, Inc. All other marks displayed on this document are the property of their respective owners. Photos herein are the property of their respective owners. Use of these images without the express written consent of the owner is prohibited.